

**STUART
OLIVER**
RESIDENTIAL



Flat 1, 190 West Street, Bristol, BS3 3NB
£159,950 Leasehold

Flat 1, 190 West Street, Bristol, BS3 3NB



- Close to local amenities
- Ground floor apartment
- Spacious reception room
- Open plan modern kitchen
- Modern bathroom
- Double bedroom
- Own front door straight from street
- No onward chain
- Ideal first time buy
- Excellent buy to let

A delightful ground floor flat with its own independent access. The flat offer spacious accommodation throughout including an open plan reception room/modern white kitchen with lots of eye and base level storage and work surface incorporating a breakfast bar, one double bedroom and a modern bathroom. This property would make a fantastic first time buy or investment property. This ground floor apartment is offered for sale with no chain!





Upon entering the property via its own independent street access, you are greeted by a good sized entrance area which in turn leads to a spacious reception room and modern kitchen with tasteful wood effect flooring throughout, these two areas are separated by a modern peninsular unit/breakfast bar, offering a great social space for entertaining! The kitchen area has ample granite effect work surface and modern white base and eye level units incorporating a built-in electric hob with oven under and extractor fan over, there is space and plumbing for a washing machine and an upright fridge/freezer. There is a double bedroom is to the front of the building. The modern bathroom is a good size and has a modern white bathroom suite with a wall mounted shower attachment incorporated in the bath and a storage cupboard. The property occupies a convenient location for access to North St (0.8 miles), City Centre (2.5 miles), Ashton Court (1.7 miles) and the Harbourside (2 miles), making it a perfect and affordable location from which to best enjoy all the benefits of this wonderful city. This property is sure to attract a lot of interest from first time buyers and investment buyers so book an appointment early to avoid disappointment.



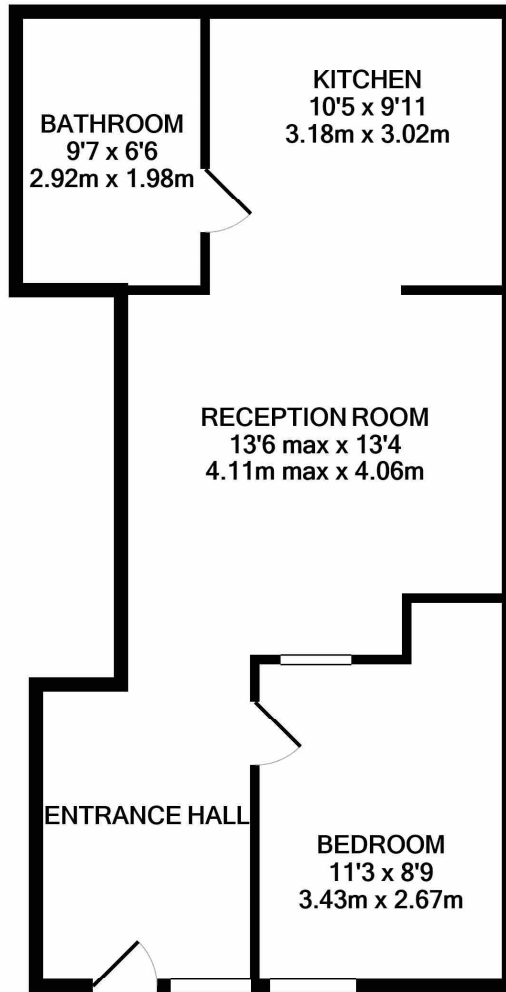

TOTAL APPROX. FLOOR AREA 511 SQ.FT. (47.5 SQ.M.)

Whilst every attempt has been made to ensure the accuracy of the floor plan contained here, measurements of doors, windows, rooms and any other items are approximate and no responsibility is taken for any error, omission, or mis-statement. This plan is for illustrative purposes only and should be used as such by any prospective purchaser. The services, systems and appliances shown have not been tested and no guarantee as to their operability or efficiency can be given

Made with Metropix ©2020

